

FAST™

KICKR™



USER

INSTRUCTIONS



FAST™ KICKR™ was developed specifically for the EOTech® Vudu® 3-9x32 SFP at the request of USSOCOM. FAST™ KICKR™ also accepts the new EOTech® Vudu® 4-12x36 FFP, all Trijicon® ACOG®, VCOG® and Primary Arms® MicroPrism™ optics. The optional MRDS Ring (sold separately) utilizes a FAST™ Optic Adapter Plate to mount an MRDS at the 12 o'clock position on its self-indexing / anti-rotational ring.

One (1) FAST™ KICKR™

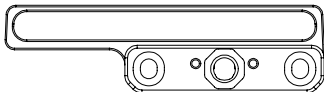

One (1) Rail Clamp



Two (2) Washers



Two (2) Clamp Screws



Two (2) Optic Mounting Screws



**WARNING:****ENSURE FIREARM IS UNLOADED****CAUTION:**

Over-torquing fasteners can damage your mount and/or your optic and will void your warranty. Using thread locking compounds, such as Loctite® or others, is not recommended and will void your warranty.

ATTACHING YOUR FAST™ OPTIC ADAPTER PLATE TO YOUR FAST™ OFFSET OPTIC BASE

**NOTE:**

If using the optional MRDS Ring for FAST™ KICKR™, this must be installed on the optic prior to installing the optic to the FAST™ KICKR™ mount body. If not using the optional MRDS Ring, jump to the next section.

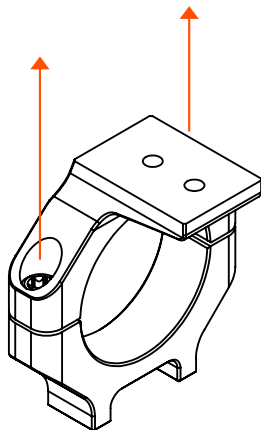
**1**

Remove the two preinstalled Rings Screws on your MRDS Ring for FAST™ KICKR™, allowing you to separate the two halves of the ring body.

2

Install the FAST™ Optic Adapter Plate to the top half of the MRDS Ring for FAST™ KICKR™ with included hardware as shown. **Torque to 18 in-lbs [2 Nm].**

3

If using the FAST™ Optic Adapter Plate for an RMR® footprint install the mini red dot with the UNITY® included hardware. For all other FAST™ Optic Adapter Plates, use the manufacturer's hardware. Do not exceed the Optic manufacturer's recommended torque spec.

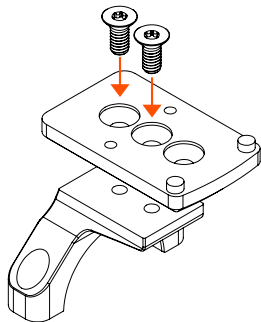

4

Position the bottom half of your MRDS Ring around your Vudu® 3-9x32 SFP (or similar) with the locating notch facing downward. Attach the top half using the 8-36 x 1/2" Ring Screws you set aside in step one. Ensure the mini red dot is level and tighten Ring Screws with a T25 bit driver. **Torque to 35 in-lbs [2.8 Nm].**

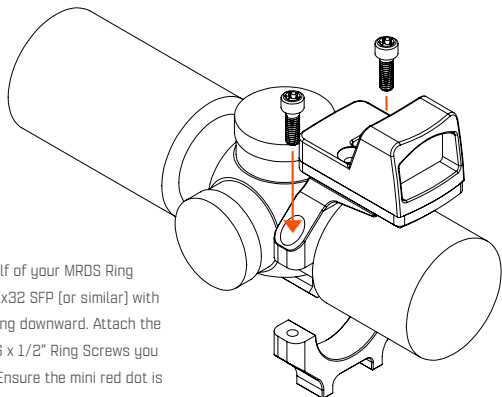

INSTALLING THE VUDU® 3-9X32 SFP [OR SIMILAR] ON FAST™ KICKR™

1

Remove the pre-installed Rail Clamp and two Clamp Screws / Washers from the FAST™ KICKR™ mount.

2

Using the UNITY® supplied Optic Mounting Screws, install the optic to the mount, inserting the screws from the bottom of the mount. If using the optional MRDS Ring, ensure the slots at the bottom of the ring secure on either side of the FAST™ KICKR™ mount. Secure the two screws using a T25 bit driver. Lightly snug all screws before applying the final torque. **Torque to 50 in-lbs (5.5Nm).**

3

Loosely reinstall Rail Clamp and three Clamp Screws / Washers.

4

Place optic mount assembly onto M1913 Rail in desired location. Push mount forward against recoil lug. Tighten Clamp Screws in order – Front, Rear, Middle – using a T25 bit driver. Lightly snug all screws before applying final torque to any screws. **Torque to 35 in-lbs (4Nm)**

