

AXON™ XL



USER

INSTRUCTIONS



AXON™ XL brings additional functionality to the industry-leading AXON™ family. The forward two buttons feature the same tactile differentiation as AXON™, while a prominent wall separates the flat (pill-shaped) center pad from the rear (flat circular) button. AXON™ XL can be mounted on MIL-STD M1913 or M-LOK®.

One (1) AXON™ XL

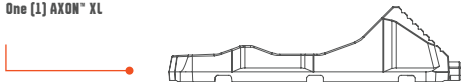

One (1) Rail Clamp A (Round Holes)



One (1) Rail Clamp B (Hex Holes)



Three (3) Cross Bolts



Three (3) Hex Nuts



T10 TORX L-KEY

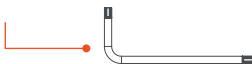

One (1) AXON™ XL Front Screw Cover



One (1) AXON™ XL Rear Screw Cover



**WARNING:****ENSURE FIREARM IS UNLOADED****CAUTION:**

Over-torquing fasteners can damage your mount and/or your optic and will void your warranty. Using thread locking compounds, such as Loctite® or others, is not recommended and will void your warranty.

**NOTE:**

If using mini zip ties (sold separately) for cable management, install them prior to placing assembly on rail. Secure zip ties in loose loop for now.

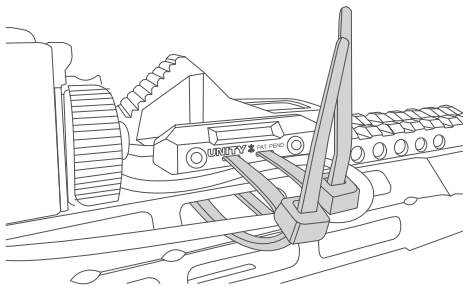

1

Place the AXDN™ XL Control Module on M1913 Rail in desired location.

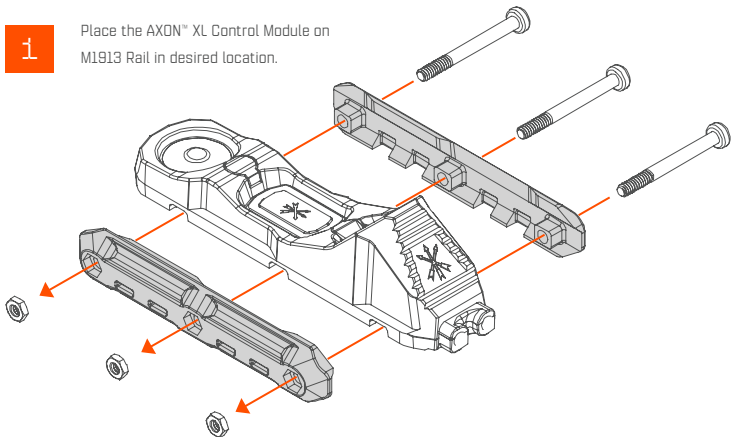

2

Align the Rail Clamps along the side of the AXDN™ XL Control Module ensuring the logo on Rail Clamp A is upright and the zip tie pass-throughs are on the bottom.

3

Fully seat the Hex Nuts in the recesses in Rail Clamp B.

4

Thread the Cross Bolts in the circular holes in Rail Clamp A via the pass-through and into the Hex Nuts in Rail Clamp B. Finger tight both before applying torque to either.

Torque to 5 in-lbs (0.57 Nm).

5

Route cables from AXON™ XL to devices and fully seat plugs in sockets. Avoid sharp bends and routing over extreme heat areas and sharp edges. If using zip tie loops for cable management, carefully pass slack cable through loops and tighten ties.

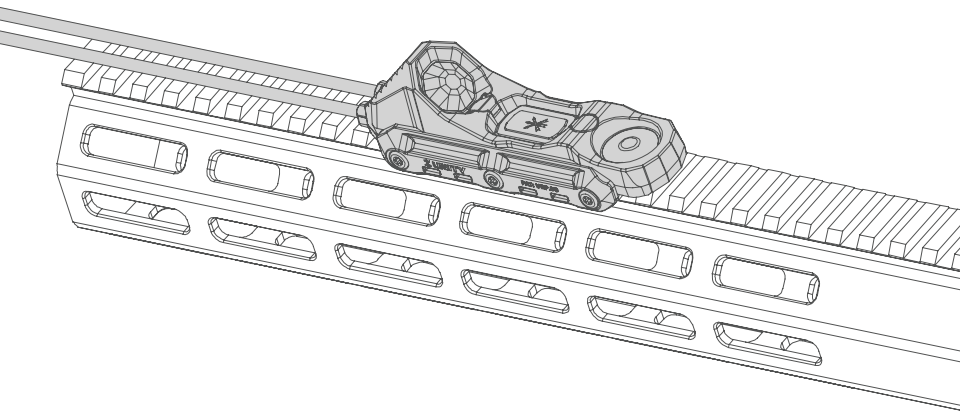

OPERATION

AXON™ XL for the Wilcox® BOSS Xe™ or RAID Xe™ is available in either standard or SYNC variants. Standard models offer an angled button that fires the flashlight only while the angled button on the SYNC models fire the laser and the flashlight simultaneously.

AXON™ remote configuration options for the BOSS Xe™ or RAID Xe™ are configurable through the Wilcox Xe™ app in the Google Play Store.

DEFAULT BUTTON CONFIGURATION FOR STANDARD MODELS

FRONT BUTTON (ANGLED): Flashlight

CENTER BUTTON (FLAT PILL-SHAPED): Fire

REAR BUTTON (FLAT ROUND): Dual High Power IR Laser and Illuminator [DH I]. In Low Power switch positions, High Power laser configurations will be limited to the maximum Low Power setting.

DEFAULT BUTTON CONFIGURATION FOR SYNC MODELS

FRONT BUTTON (ANGLED): Flashlight + Dual High Power IR Laser and Illuminator [DH I]. In Low Power switch positions, High Power laser configurations will be limited to the maximum Low Power setting.

CENTER BUTTON (FLAT PILL-SHAPED): Fire

REAR BUTTON (FLAT ROUND): Dual High Power IR Laser and Illuminator [DH I]. In Low Power switch positions, High Power laser configurations will be limited to the maximum Low Power setting.

EXTREME CONDITIONS

Use of the AXDN™ line of switches in austere environmental conditions does not require any special attention or procedures for operation.

MAINTENANCE

Brush away all dirt, sand and debris with a soft bristle brush. Wipe with a damp cloth to clean.

STORAGE

The AXDN™ line of switches meets MIL-STD-810 environmental standards and can be used in extreme conditions. Ideally, do not store in extreme heat or cold long-term.

