

USER INSTRUCTIONS

For Ops-Core® ARC-style, M-LOK® and Team Wendy® EXFIL® Rail Systems

MARK™

MODULAR
ATTACH
RAIL KIT

FOR 3M™ PELTOR™-STYLE
HEADSETS



CONTENTS



PRODUCT OVERVIEW

MARK™ provides seamless integration of many popular electronic hearing protection, including all 3M™ Peltor™ ComTac™ systems with most popular helmet rails, including Ops-Core® ARC-style, M-LOK® and Team Wendy® EXFIL® rail systems.

Two (2) MARK™ Wire Forms for 3M™ Peltor™-Style Headsets

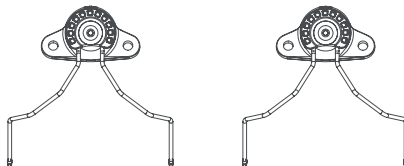

Two (2) ARC Rail Adapter Plates (Note: Not used on Team Wendy® EXFIL® rails.)



Four (4) 10-32 x 7/16 Screws



Four (4) 10-32 x 5/16 Screws



Four (4) Capture Nuts



NOTE

MARK™ M-LOK® Adapter Kit sold separately.

ATTACHING PELTORS TO MARK™



CAUTION:

IF YOUR HEADSET HAS A HEADBAND, THE HEADSET MUST BE FULLY DISASSEMBLED FROM THE HEADBAND BEFORE PROCEEDING WITH INSTALLATION. THIS MAY INCLUDE IRREVERSIBLE CHANGES, SUCH AS REMOVING A CABLE FROM A SEWN CHANNEL ON THE HEADBAND.

1

Pivot headband stems from 90° on ear cups to line up with flats on posts.

2

Pop stems off posts. Be careful not to damage C-Clamps.

3

Turn stems 90° on wire forms and pull off wires. Failing to turn stems first may result in damage to stems.

4

Reassemble in reverse order on MARK™ wire forms.

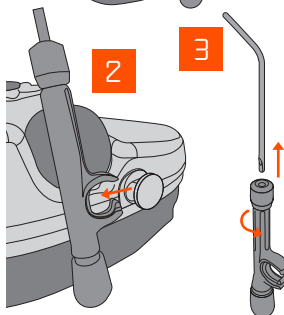
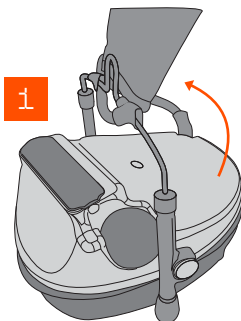

ATTACHING MARK™ TO ARC-STYLE RAILS

NOTE

The ARC Adapter Plates are designed to work with genuine Ops-Core® ARC rails. They are also compatible with similar ARC-style rails, but may require slight fitting. If the ARC Adapter Plate is too tight in a non-Ops-Core® rail, carefully remove material with a fine grit sandpaper until optimal fit is achieved.

1

Install two Capture Nuts into the rear side of the ARC Adapter Plate as shown.

2

Slide the ARC Adapter Plate assembly into the center channel of the ARC rail.

3

Using the included 10-32 x 5/16 Screws (shorter screws), secure MARK™ assembly to the backer. Lightly snug both screws before applying torque to either. **Do not exceed 10 in-lbs (1.13 Nm).**

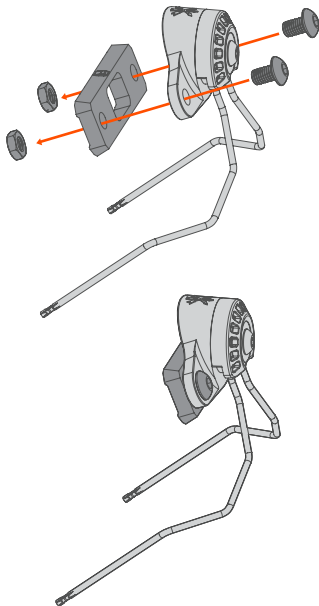

ATTACHING MARK™ TO TEAM WENDY® EXFIL® RAILS

1

If not already uninstalled, remove the two OEM screws holding the W Spacer Plate in place from both Team Wendy® EXFIL® 2.0 or 3.0 rails. Leave the W Spacer Plate in place.

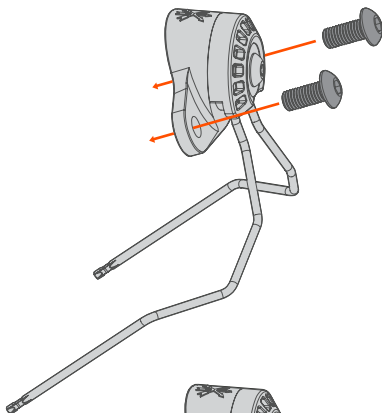

2

Using the included 10-32 x 7/16 Screws (longer screws), secure MARK™ assembly to the rail. Lightly snug both screws before applying torque to either.

Do not exceed 10 in-lbs (1.13 Nm).

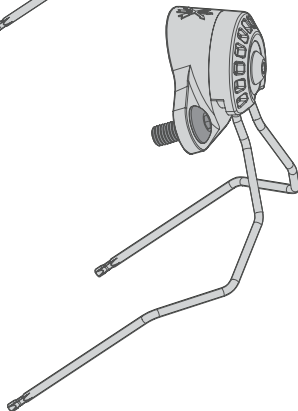

ATTACHING MARK™ TO M-LOK® RAILS



NOTE

MARK™ M-LOK® Adapter Kit
sold separately.

1

Using the 10-32 x 3/8 Screws and M-LOK® Nuts included separately with the MARK™ M-LOK® Adapter Kit, insert the Screws through the MARK™ body and into the M-LOK® Nuts as shown.

2

Secure the MARK™ assembly to the M-LOK® helmet rail using normal M-LOK® mounting procedures. Lightly snug both screws before applying torque to either. **Do not exceed 10 in-lbs (1.13 Nm).**

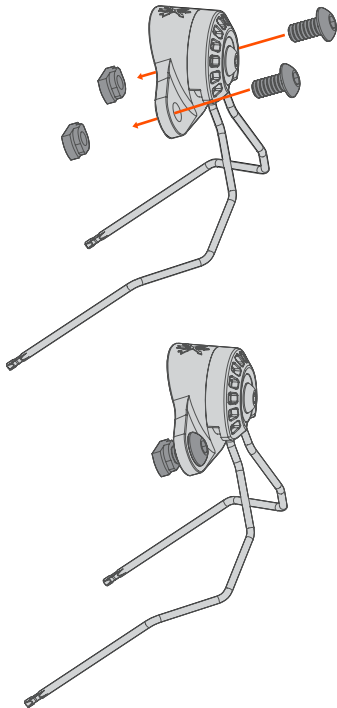

INFO@UNITYTACTICAL.COM

©2025 UNITY Tactical. All Rights Reserved.
Specifications subject to change without notice. PAT. UTIP.CO

