

INSTALLATION INSTRUCTIONS

For Busch PROtective® Rail Systems

MARK™

MODULAR
ATTACH
RAIL KIT

FOR 3M™ PELTOR™-STYLE HEADSETS



CONTENTS



PRODUCT OVERVIEW

MARK™ provides seamless integration of many popular electronic hearing protection, including all 3M™ Peltor™ ComTac™ systems with Busch PROtective® helmets.

Two (2) MARK™ Wire Forms for 3M™ Peltor™-Style Headsets

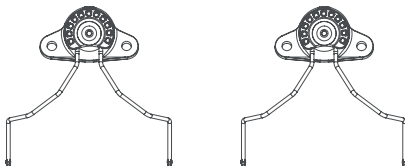

Two (2) Busch Rail Adapter Plates



Four (4) 10-32 x 5/16 Screws



Four (4) Capture Nuts



ATTACHING PELTORS TO MARK™



CAUTION:

IF YOUR HEADSET HAS A HEADBAND, THE HEADSET MUST BE FULLY DISASSEMBLED FROM THE HEADBAND BEFORE PROCEEDING WITH INSTALLATION. THIS MAY INCLUDE IRREVERSIBLE CHANGES, SUCH AS REMOVING A CABLE FROM A SEWN CHANNEL ON THE HEADBAND.

1

Pivot headband stems from 90° on ear cups to line up with flats on posts.

2

Pop stems off posts. Be careful not to damage C-Clamps.

3

Turn stems 90° on wire forms and pull off wires. Failing to turn stems first may result in damage to stems.

4

Reassemble in reverse order on MARK™ wire forms.

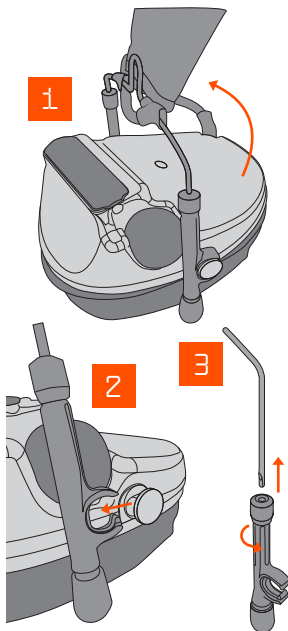

ATTACHING MARK™ TO BUSCH PROTECTIVE® RAILS

1

Install two Capture Nuts into the rear side of the Busch Rail Adapter Plate as shown.

2

Slide the Busch Rail Adapter Plate assembly into the center channel on the Busch PROTECTIVE® rail.

3

Using the included 10-32 x 5/16 Screws, secure MARK™ assembly to the backer. Lightly snug both screws before applying torque to either. **Do not exceed 10 in-lbs (1.13 Nm).**

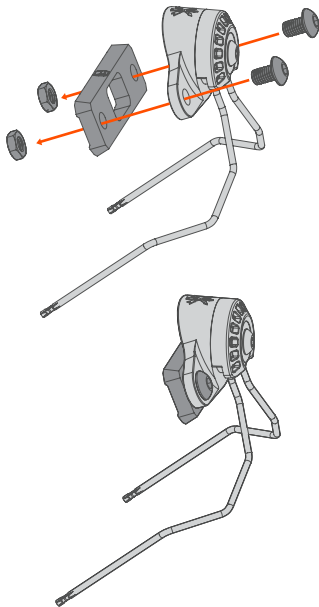

INFO@UNITYTACTICAL.COM

©2023 UNITY Tactical. All Rights Reserved.
Specifications subject to change without notice. PAT: UTIP.CO

