

INSTALLATION INSTRUCTIONS

For Busch PROtective® Rail Systems

MARK™

MODULAR
ATTACH
RAIL KIT

FOR OPS-CORE® AMP®
COMMUNICATION HEADSETS



 **UNITY™**

CONTENTS



PRODUCT OVERVIEW

MARK™ provides seamless integration of the Ops-Core® AMP® Communication Headset with Busch PROtective® helmets.

Two (2) MARK™ Wire Forms
for the Ops-Core® AMP®
Communication Headset

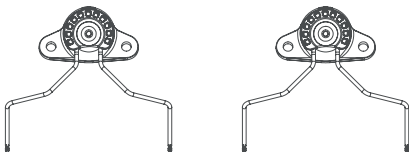

Two (2) Busch Rail Adapter Plates



Four (4) 10-32 x 5/16 Screws



Four (4) Capture Nuts



Two (2) Ops-Core® Cradle
Clamps (Optional Purchase)

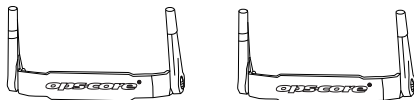

ATTACHING AMP® TO MARK™



NOTE

If your AMP® has a headband, it must be fully disassembled from the headband before proceeding with installation. Unfasten the three loop fastener cable retention tabs on the headband to free the ear-to-ear cable.

If you purchased your MARK™ with the Ops-Core® Cradle Clamps, jump to step 2.

1

Holding one side of your existing wire form, twist one of the stems 90°. Pull the stem off the wire. Repeat on second wire until the clamp is fully detached on both sides. Then, repeat on second ear cup.

2

Holding one side of your MARK™ wire form, twist one wire 90° from the final origin of the clamp and insert it fully into the stem. Repeat on second wire until the clamp is fully attached on both sides. Then, repeat on second ear cup.

3

If not already attached to each ear cup, ensure the logo on the Ops-Core® Cradle Clamp is properly oriented right-side up, and the arrow on the inside of the clamp is pointing up. Insert one side of the Cradle Clamp into the hole on the side of the ear cup and push down to snap it in place. Repeat on opposite side until you hear a click and find it fully attached. Repeat on second ear cup.

ATTACHING MARK™ TO BUSCH PROTECTIVE® RAILS

1

Install two Capture Nuts into the rear side of the Busch Rail Adapter Plate as shown.

2

Slide Busch Rail Adapter Plate assembly into the center channel on the Busch PROtective® rail.

3

Using the included 10-32 x 5/16 Screws, secure MARK™ assembly to the backer. Lightly snug both screws before applying torque to either. **Do not exceed 10 in-lbs (1.13 Nm).**

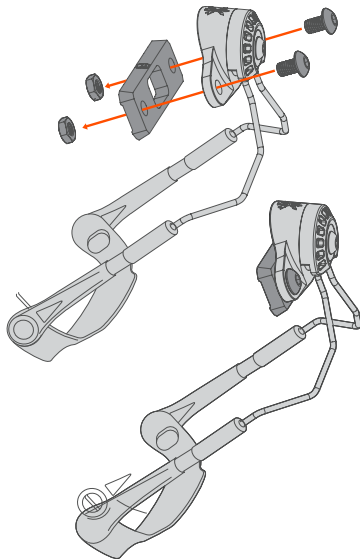

INFO@UNITYTACTICAL.COM

©2023 UNITY Tactical. All Rights Reserved.
Specifications subject to change without notice. PAT: UTIP.CO

