

MARK™ MTEK RAIL KIT

INSTALLATION INSTRUCTIONS



⚠ BEFORE INSTALLATION

Remove headset from OEM headband assembly.

1. Pivot headband stems from 90° on ear cups to line up flats on posts.
2. Pop stems off posts.
3. Turn stems 90° on wire forms and pull off wires.
4. Reassemble in reverse order on MARK wire forms.

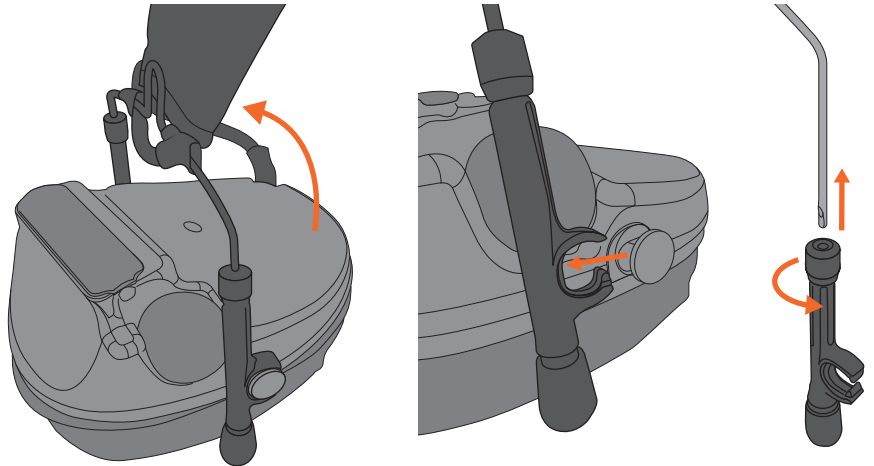

INSTALLATION

Remove Center Screw/Washer, Top Cap, and Wire Form from hub assembly. Remove two Socket Head Cap Screws and MARK Center Section. Loosen Center Screw/MLOK Nut through MARK Rear Plate to prepare for install on MLOK Helmet Rail Section.

- 1 Place MARK MLOK Backer Assembly into desired position on helmet MLOK Rail.
- 2 Once assembly is in desired location, tighten Center MLOK Screw (finger tight). Ensure MLOK Nut is fully perpendicular to MLOK Slot. If not, completed MARK assembly could pop off rail under pressure.
- 3 Place MARK Center Section over installed MARK MLOK Plate Assembly. Install two Socket Head Cap Screws and tighten (finger tight).
- 4 Place MARK Wire Form Arm with attached OEM headset onto installed MARK Center Section Assembly.
- 5 Slide MARK Top Cap onto MARK Lower Assembly from the top down.
- 6 Reinstall Washer and Center Screw. The screw should be finger tight. Tension adjustment can be made from there depending on individual preference. MARK is designed to pivot on rail for stowage when not in use.

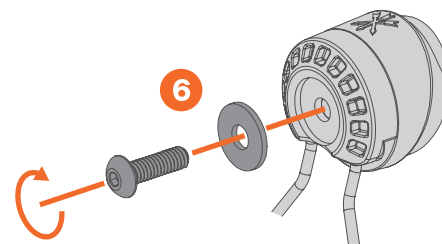
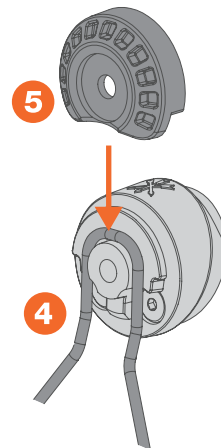
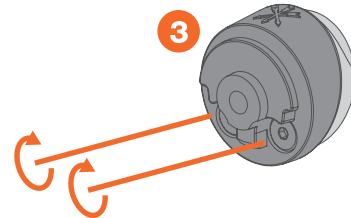
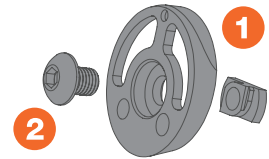

NOTE: MARK System can be used with MSA/Sordin-based headsets with addition of UNITY Tactical SARA (Sordin ARC Rail Adapter) Kit, sold separately.